



FOR IMMEDIATE RELEASE

Contact:

Jamie Hendricks

Truck Safety USA, LLC

615 S. Church Street, Virden IL 62690

info@trucksafetyusa.com www.trucksafetyusa.com

Truck Safety USA, LLC. is Proud to Announce the Unveiling of DUMP BRACE™ & CAB BRACE™:

Revolutionary Innovations in the Fleet Maintenance Support Equipment Industry.

Virden, Illinois. February 21, 2018. There is a direct correlation between safety equipment and simplicity. It is ONLY when these two go hand-in-hand, that we are able to drastically reduce the potential for maintenance related injuries & fatalities in the field of Fleet Services. Bulky, time consuming & difficult to properly install products, leave the door open for a tremendous amount of human error, which could have otherwise been easily prevented.

With the Introduction of DUMP BRACE™ & CAB BRACE™ to the fleet maintenance market, the above mentioned potential for on the job injuries can be nearly eliminated. Our main objective at Truck Safety USA was to develop products that ensured simple, swift installation, all the while minimizing the margin for human error. With their streamlined design and patent pending clamping mechanisms, we've accomplished these goals.

Both DUMP BRACE™ and CAB BRACE™ serve the same purpose for two separate markets. Please see product specifications on the following pages, as well as an overview of how each product functions.

DUMP BRACE™ Product Specifications

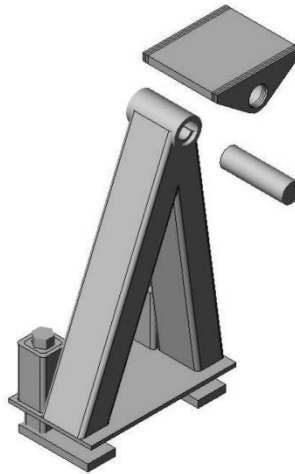

HOW DUMP BRACE™ WORKS:

Three simple steps are all it takes to securely lock DUMP BRACE™ into position: First, the dump bed is raised to the optimum height. Next, the DUMP BRACE™ is placed on the truck frame member and moved towards the raised dump bed frame. Once situated between the two frames, the operator then secures the clamping mechanism by tightening its base plate bolts.

The design of our patent pending clamping mechanism has fully eliminated the need for dual operator installation, as a pair of DUMP BRACES can be installed and secured by a single mechanic in less than a minute. The DUMP BRACE™ design has led to a drastic decrease in the amount of time spent beneath an unsecured raised bed during support mechanism installation, therefore decreasing the potential for work related injury. DUMP BRACE™ will cover any standard flange width up to 6", as well as offset frame applications.

- Total Weight 45 lbs.
- Overall Height 19.5 in.
- Overall Length 11.0 in.
- Overall Width 6.0 in

CAB BRACE™ PRODUCT SPECIFICATIONS

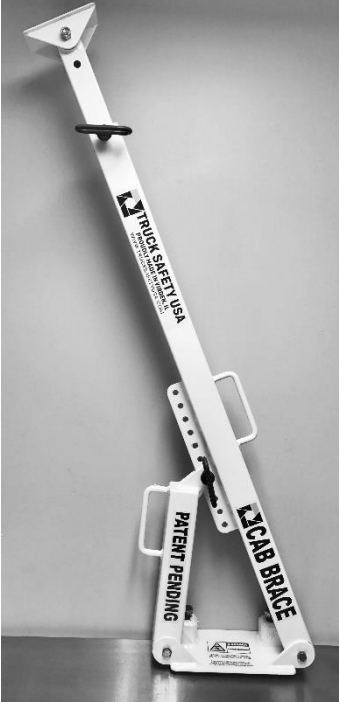

HOW CAB BRACE™ WORKS:

CAB BRACE™ was designed as a safety support mechanism for specific use during Cab Over Engine Truck Maintenance. Our main goal at Truck Safety USA was to design a product that would optimize your installation and safety procedures, in a seamless & simple fashion, to keep your team safe always. CAB BRACE™ offers a range of both height and angle adjustability, and it's sleek, compact design allows your staff ample working space by minimizing unnecessary obstructions.

Just a few simple steps are all it takes to secure CAB BRACE™ into position: With the truck cab stationed in it's tilted-open position, place CAB BRACE™ on the truck frame member, with clamping mechanism beneath the flange. Next, adjust the height and angle of the CAB BRACE™ by utilizing the convenient hitch pins to set as needed to perform desired maintenance. Once the height and angle have been set, move CAB BRACE™ toward cab frame to wedge between cab frame and truck frame. Using a ratchet, tighten both base plate bolts to engage the clamping mechanism.

- Total Weight 49 lbs
- Adjustable Height Range 52 in. min – 88 in. max
- Overall Length 14.0 in.
- Overall Width 6.0 in

Truck Safety USA, LLC. Is headquartered in Virden Illinois, with all product components being designed, sourced and manufactured by and within the United States of America.

Keeping your team safe is and always will be at the top of our list.

For further information on products & services offered by Truck Safety USA, LLC, please visit:

www.trucksafetyusa.com

info@trucksafetyusa.com

Phone/Fax + 1 217.965.3941

615 South Church Street

Viriden, Illinois 62690